

October 2018

CHANGE ORDER

CONSTRUCTION SPECIFICATIONS INSTITUTE CHICAGO CHAPTER



Gettin' Social With It

If you are following CSI Chicago on Social Media you have noticed an increased amount of posts and content within the last month. The Communication and Social Media Committees have worked together to increase our activity to keep members informed and to attract new members.

Learn more on page 14.

Follow us:



QUICK LINKS

UPCOMING EVENTS
PRESIDENT'S LETTER
SPONSORSHIP OPPORTUNITIES
MEMBER NEWS
CHAPTER NEWS
LEADERSHIP DIRECTORY



Chicago Chapter
Founded 1953

773-466-4147
info@csichicago.org
www.csichicago.org

TABLE OF CONTENTS

- PRESIDENT'S LETTER
- UPCOMING EVENTS
- CERTIFICATION
- MEMBER NEWS
 - ANNIVERSARIES & NEW MEMBERS
 - MEMBER SPOTLIGHT
 - BEYOND THE CHAPTER
- CHAPTER NEWS
 - EVENT RECAP
- HOT TIP OF THE MONTH
- SPONSORSHIP AND MARKETING
 - UPCOMING OPPORTUNITIES
 - PARTNERSHIPS & MARKETING
- INSTITUTE & REGIONAL NEWS
- INDUSTRY EVENTS
- LEADERSHIP DIRECTORY
 - OFFICERS & DIRECTORS
 - COMMITTEE MEMBERS & COORDINATORS
- CONTRIBUTED ARTICLE
- THE CLOSEOUT



Outstanding Chapter Commendation
Chicago Chapter 13 time award recipient

UPCOMING EVENTS

Special Considerations for Reroofing Low-slope Commercial Roof Assemblies

Technical Roundtable: Wednesday, October 10, 2018, 12:00pm

Specification Strategies for Covering all the Bases of NFPA 285

Specifier Roundtable: Thursday, October 11, 2018, 12:00pm

Persistence and Overcoming Objections

Industry Roundtable: Friday, October 19, 2018, 12:00pm

Virtual Reality in Construction

Chapter Meeting: Tuesday, October 23, 2018, 5:00pm

Meet the Reps: Exterior Insulation and Finish Systems (EIFS) Panelization

Meet the Reps Roundtable: Friday, November 2, 2018, 12:00pm

SAVE THE DATE

Chapter Meeting: Tuesday, November 27, 2018, 5:00pm

Holiday Party: Thursday, December 13, 2018, 5:30pm

CDT Exam Study Class: Begins January 2019

Building Enclosure: Thursday, February 26, 2019

CSi2eye: Thursday, March 14, 2019

President's Letter



Dear esteemed members,

Thank you to all who came out for Trivia Night at Ballast Point Brewery. It was a great way to kick off the year, and for our resident trivia master Jeremy Olsen to stump some of the brightest people in Chicago in a venue of his own design. It was great to see so many new faces among old friends as the event doubled as our new member reception, welcoming new comers into the Chapter with some fun. As I mentioned at the event, I strongly believe that this organization is

a wonderful place for all who are involved in the construction industry, and the more you get involved, the more rewarding it gets. Thank you to Jeremy, and to our generous event sponsors; Blue Line Building Products, MAPEI, HILTI, General Shale Arriscraft, and Aristech Surfaces.

We had a very successful contractor engagement month in September. We highlighted the month with our Chapter Meeting at Skender. Their Chief Design Officer, Tim Swanson, had an incredibly enlightening presentation for our group focused on inefficiencies in standard project delivery, and how prefabrication may offer solutions to some of those issues. I want to thank Tim and Skender for their efforts in making this program possible and inviting us into your office for the evening. We ended up with a full house, and we're expecting more of the same going forward, so please keep an eye on upcoming events and register early to reserve your spot.

If you're one of our members that consistently makes it out to our Chapter Programs, and hasn't been able to attend a social event, roundtables, or one of our many other events, I encourage you to keep an eye on the program for this year. Beyond our educational and social offerings, it's been incredible to see some of charitable efforts driving forward this year with some exciting things planned.

As you look to get more involved, we have made communicating and connecting with the chapter easier, and more secure. Our outreach will now utilize the following emails and a new upgraded and simplified URL:

Website URL: www.csichicago.org

Executive Director, Beth Winkler: administration@csichicago.org

Membership Team: membership@csichicago.org

Certification Team: certification@csichicago.org

General Inquiries and News: info@csichicago.org

Another big driver of our outreach efforts this year has been in the way Brad Schwab and our communications committee have been expanding our digital presence to bring more attention to our activities. If you are active on a social media platform; LinkedIn, Facebook, or Twitter, please follow us to get the most up to date news about what's going on with CSI Chicago. It's a great way to stay current with not only the chapter, but our industry partners from around Chicago as well.

President's letter continued on the next page...

PLATINUM CHAPTER PARTNERS

Senergy[®]

BEHR

BLUE LINE
BUILDING ★ PRODUCTS

Elemax[®] 2600
Air & Water-Resistive Barrier

Henry[®]

INTERNATIONAL
The future. Illuminated.
2018

MARVIN 
Windows and Doors

 **MAPEI**[®]

 **Oldcastle BuildingEnvelope**[®]

DuPont[™]
Tyvek[®]

distributed by **Parksite**

 **COMMERCIAL**

 **PAC-CLAD**[®]
P E T E R S E N

 **WOODLAND**
WINDOWS & DOORS

Want to contact a representative of
our Platinum Partners? [Click here.](#)

President's Letter (cont.)

Speaking of our communication committee, this month CSI Chicago heads down to CONSTRUCT in California, where we will be receiving Institute Awards for our Chapter website and marketing materials. It's a testament to the hard work of our organization, and the success we have had tailoring our approach to connecting with our members and the construction industry. Those are not the only rewards we will be receiving this year, as our Contractor Engagement Committee is the well deserving recipient of the J. Norman Hunter Award for Innovative Allied Organization Cooperation. This is an exciting award for our chapter to be receiving as we've made a concise effort over the past few years to diversify our organization with influential voices from all construction stakeholders. Congratulations to Jennifer Friedland and the Contractor Engagement Committee.

I'm very excited for our next Chapter meeting. On October 23rd, we are very excited to welcome Josh Rodgers and Mortenson in for Virtual Reality in Construction, a program that will share how the technology is rapidly changing construction and design. The program will be held at the East Bank Club, and will fill up fast. Registration is now open.

I'm looking forward to meeting as many of you as possible this year. I am proud of the work we have done in organizing a strong line up of educational programs, and outreach efforts. Please contact Beth Winkler at the above email for any information on how to get engaged with our Chapter, as we are always looking for fresh ideas and new voices.

Peter W. Grotenhuis, CSI, CDT



	<p>Mark R. Nelson President</p> <p>Nelson Testing Laboratory 717 Industrial Drive Elmhurst, IL 60126</p> <p>Ph.: 630-501-0230 Fax: 630-501-0270</p> <p>mnelson@nelsontesting.com www.nelsontesting.com</p>
---	---

GOLD CHAPTER PARTNERS



Want to contact a representative
of our Partners? [Click here.](#)

GOLD CHAPTER PARTNERS



Want to contact a representative
of our Partners? [Click here.](#)

Virtual Reality in Construction

Chapter Meeting: Tuesday, October 23, 2018

Presented by: Josh Rodgers | Integrated Construction Manager | Mortenson

Mortenson is leveraging Virtual Reality (VR) to enhance both customer outcomes and project outcomes. By using VR and other technologies, they have assisted customers with fundraising, sales, and training. By integrating in the design phase as well as construction phase, the project teams are able to make decisions faster and easier in a collaborative virtual environment.

Mortenson will have Virtual Reality demonstrations taking place during the social time so attendees can have an opportunity to get a close up VR experience.

Location: East Bank Club, Chicago

Time: 5:00pm-8:00pm*

Cost: Complimentary to CSI Chicago Members; Nonmembers \$55 (includes dinner)

Registration: Due by October 16, 2018

Continuing Education: 1.0 AIA/CES LU



*at 4:00pm we will hold a reception to honor Scott Conwell and Kurt Moelmann for the high honors they received at the CSI Institute Awards on October 4. Appetizers and cash bar will be available.

[REGISTER NOW](#) 

Learning Objectives:

1. Understand what virtual reality is.
2. Review how virtual reality is applied to support construction projects and customers' business outcomes.
3. Explore project examples and case studies of how Mortenson uses virtual reality.
4. Participate in an interactive session demonstrating virtual reality to the audience.



About the Presenter:



Josh Rodgers is an Integrated Construction Manager for Mortenson Construction, with 11 years in the industry. Josh manages the VDC department in Seattle as well Virtual Insights, which is a customer facing technology group within Mortenson. Through the implementation of VDC Josh adds value to project delivery including safety, quality control, and cost and schedule reduction. Virtual Insights offers specialized services in Virtual Reality, Augmented Reality, and other emerging technologies to enhance customer's business outcomes.

Lunchtime Roundtables

Specifier Roundtable: Specification Strategies for Covering all the Bases of NFPA 285

Thursday, October 11, 2018, 12:00pm - 1:00pm

Facilitated by: Melissa Gibson, NCARB, CSI, CCS, CCCA, LEED AP BD+C | Epstein

Learn multiple approaches for specifying wall assemblies and their components to meet NFPA 285 requirements and understand how carefully crafted specifications can ensure that those requirements are not sidestepped during construction administration. [Complete event listing.](#)

Location: Epstein, Chicago or by webcast

REGISTER NOW 

Technical Roundtable: Special Considerations for Reroofing Low-slope Commercial Roof Assemblies

Wednesday, October 10, 2018, 12:00pm - 1:00pm

Presented by: Allysia Youngquist, AIA, RCI, NCARB—Associate Principal, Klein & Hoffman
Jason Wilen, AIA, CDT, RRO—Senior Associate I, Klein & Hoffman

Explore the typical design and installation considerations for Low-rise Commercial Roof Assemblies when installed on existing buildings. Allysia Youngquist and Jason Wilen of the Chicago firm Klein and Hoffman will share their insights into this common but complex building restoration project type. [Complete event listing.](#)

Location: Klein & Hoffman, Chicago

REGISTER NOW 

Industry Roundtable: Persistence and Overcoming Objections

Friday, October 19, 2018, 12:00pm - 1:00pm

Presented by: Thomas Herman, Managing Director | Chicago Executive Roundtable

“Fatigue makes cowards of us all,” is a quote attributed to both General George S. Patton and Vince Lombardi. Whether you are a design professional pursuing new clients or a construction product representative generating revenue for your company, the sales process never stops, and is often filled with obstacles like objections. This seminar addresses the keys to persistence, even when the road to revenue may seem difficult. It also takes a critical look to objections, how to identify them, and how to overcome them. Thomas Herman, managing director of the Chicago Executive Roundtable helps sales leaders and individual contributors grow revenue for themselves and for their companies.

[Complete event listing.](#)

Location: Thornton Tomasetti, Chicago

REGISTER NOW 

Meet the Reps Roundtable: Exterior Insulation and Finish Systems (EIFS) Panelization

Friday, November 2, 2018, 12:00pm - 1:00pm

Panelists: BASF - David Meyers CCPR, Territory Sales Manager

Dryvit Systems, Inc. - John Ratter, Midwest Regional Sales Manager

Sto Corp. - Kristin Henriksen, CSI, CDT, Sales Representative

This roundtable will give you the opportunity to get to know local representatives and learn about product selection and their applications in the market. Participants are encouraged to come prepared with questions in this open discussion format. [Complete event listing.](#)

Location: Antunovich Associates, Chicago

REGISTER NOW 

Certification Certification Reinstatement

Last Call for Special Reinstatement Certification Program

October 15, 2018: Reinstatement period ends

CSI acknowledges that past communication regarding renewal requirements for CSI certifications has been inconsistent. To address this issue and provide a solution, CSI is offering a one-time Lapsed Certification Reinstatement Program.

The one-time reinstatement period will be open April 15 to October 15, 2018. This offer is available to any individual having held a CSI certification which lapsed on or after June 30, 2014.

The following certifications will be included in the program:

- Certified Construction Contract Administrator (CCCA)
- Certified Construction Specifier (CCS)
- Certified Construction Product Representative (CCPR)

The Lapsed Certification Reinstatement Program offers a clear path for applicants to update their credentials.

[Learn More](#)



**DISTINCTIVE
STYLE**

NEW Precision Series Tiles
for Roofs and Walls



Federal Center South Building, Seattle, WA Architect: ZGF Architects Design-Build Contractor: Sellen Construction Profile: TS Tile

FOUR UNIQUE PROFILES
Introducing an exciting collection of stamped metal tiles that expands design possibilities for exterior cladding.

Precision Series Tiles are a cost-effective, striking design alternative for commercial or residential projects. The tiles may be installed vertically, horizontally or at an angle.

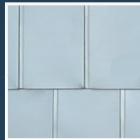

PAC-CLAD
PETERSEN

			
CUPPED TILE	FLAT TILE	DIAMOND TILE	TS TILE

PAC-CLAD.COM IL: 1 800 PAC CLAD
MD: 1 800 344 1400 TX: 1 800 441 8661
GA: 1 800 272 4482 MN: 1 877 571 20

 PACGREENINFO.COM
YOUR GREEN METAL RESOURCE

Member News

Anniversaries and New Members

Continuous years with CSI...

60 Edward Schroeder, CSI, Member Emeritus
Spec. Consultant

54 Milton Potee, FCSI, Member Emeritus
Retired

37 Denny Lawson, CSI, CDT
Denny Lawson

29 David Spalding, CSI
American Hydrotech, Inc.

28 Renee Doktorczyk, CSI, CCS, AIA, FAIA, SCIP
ArchiTech Consulting, Inc.

24 Patrick Duffy Jr., CSI, CCPR
Advanced Building Products

23 Lynn Javoroski, FCSI, Member Emeritus, CCS, LEED AP, SCIP

22 Chris Walsh, CSI, CDT
Inpro

20 Randall Chapple, CSI, CCS, AIA, SE
Goettsch Partners

17 John McMillan, CSI
Madden McMillan Architects

13 Michael Lough, CSI, CDT, AIA, NCARB
Integral Consulting, LLC

12 Scott Wolff, CSI, CDT
Henry Company

11 Scott Conwell, CSI, CDT, AIA, ALA, FAIA, LEED AP
International Masonry Institute

10 Theodore Herr, CSI, CDT, AIA
Theodore W. Herr, AIA, CSI, CDT

6 Drew Clausen, CSI
Owens Corning

6 Kenneth Soch, CSI, CDT
Solomon Cordwell Buenz

6 Elaine Szot, PE, CSI

5 Thaïs Heintz, CSI-EP, CDT
Legat Architects

4 David Thomas, MBA, CSI-EP, CDT
LP Building Products

Section continued on the next page...

NEED SUBFLOOR SOLUTIONS? WE'VE GOT YOU COVERED.

- PRIMERS AND MOISTURE MITIGATION SYSTEMS
- REPAIR, PATCHING, AND SMOOTHING COMPOUNDS
- FLOOR LEVELING COMPOUNDS AND UNDERLAYMENTS
- WATERPROOFING MATERIALS
- ADHESIVES



The best floors are based on subfloors from



GE Silicones

AIR & WATER-RESISTIVE BARRIER COATING

Beneath the façade, above the rest.



- Unlimited UV exposure
- Excellent performance in open joint rain screen systems
- Building Code and NFPA 285 compliant
- Warranties available up to 20 years
- One-coat, primerless application
- Rain ready in as little as 30 minutes
- Cold weather application down to 0° F/-18° C

Bring built-in resilience to your next project.

((specify today)) siliconeforbuilding.com

Before purchasing or using any Momentive products, please visit www.siliconeforbuilding.com/LegalDisclaimer to view our full product and sales disclaimer.

GE is a registered trademark of General Electric Company and is used under license by Momentive Performance Materials Inc.

*Elemax is a trademark of Momentive Performance Materials Inc.

Copyright 2018 Momentive Performance Materials Inc. All rights reserved.



Toll Free: 855.391.2649 www.hpsubfloors.com

Member News

Anniversaries and New Members (cont.)

Continuous years with CSI... (cont.)

- 4 Steven Smock, CSI
Weather Shield Manufacturing
- 4 John Stumpf, CSI
Mitsubishi Chemical Composites America, Inc.
- 4 Eric Kuhlman, CSI
Benchmark By Kingspan
- 3 Valerie Vlahos Maes, CSI
Flexco
- 3 Wesley Sherrer Jr., CSI
Carlisle RFC
- 2 Nicholas Schalmo, CSI
Modernfold Chicago, Inc.
- 1 Mario Goncalves, CSI
UL CLEB
- 1 Anthony Flaim, CSI
- 1 Tiffany Flaim, CSI
- 1 Steven Fisher, CSI-EP
SF Specisltied
- 1 Spencer England, CSI-EP, AIA
BathFitter

- 1 James Lavagnino, CSI
- 1 Michael Geary, CSI
- 1 Lindell Roberson, CSI-EP
- 1 John A Richards, CSI
Universal Forest Products Alternative Materials
- 1 Aubrey Swift, CSI
DBHMS

Welcome to the Chicago Chapter...

Cris Bierschank, CSI, ASHRAE, LEED GA, USGBC
(5 year CSI member)
MAPEI Corporation

James Creed, CSI
Denise Mueller, CSI
Mike Rickerson, CSI
ATAS International
Johardy Sunandjaja, CSI-EP
Armstrong Ceilings Solutions
Serena Vescoso, CSI

Share with CSI Chicago

Share your personal or professional news and achievements by notifying the chapter at administration@csichicago.org for inclusion in the following month's newsletter.

John Meany is now the Regional Sales Manager for Advanced Building products. Advanced Building Products has become the fastest growing manufacturer of entangled net products in the United States. Widely known for our Mortar Break® and quality asphaltic and non-asphaltic copper laminated flashings, Advanced Building Products continues to expand its product offering to provide moisture solutions for the full scope of your project from above to below grade. Please feel free to contact John @ 207-651-9051 or jmeany@abp-1.com.



Wall systems from BASF help your project succeed. With energy efficiency, fire performance, and cost benefits far superior to Metal Composite Materials (MCM) - Music City Motor Cars is a proven example. By incorporating BASF Metallic Effects on a BASF Continuously Insulated (CI) wall system, this project complied with building code requirements and provided a look that exceeded the architect's expectations.

Design Flexibility. Code Compliance. Performance. Let BASF help with the building science, so you can focus on designing the building your clients desire.

Contact David Meyers (david.meyers@basf.com, 630-423-1980)

BASF Corporation - Wall Systems | Jacksonville, FL | P: 800.221.9255 | www.senergy.basf.com

Member Spotlight

Michael Lough, CSI, CDT, AIA, NCARB



Michael J. Lough is the Founder/Principal of Integral Consulting LLC. He founded Integral Consulting in 2006, a firm which focuses on building enclosure services and quality control peer review services. The principal aim is to assist in making projects better; focus on coordination, performance, regulations, and good detailing.

Thirteen years ago, Mike joined CSI to learn from and to interface with professionals who appreciate how important it is to understand materials and systems and their integration into building detailing interfaces that make up the fabric of buildings.

When reflecting on the projects in his career, 340 on the Park is the most memorable. 340 on the Park is the second tallest all-residential building in Chicago and Millennium Park. SCB (former employer) worked to design a great building with structural and MEP/FP consultants along with the contractor, Lend Lease. It was a pleasure and honor to be part of the team.

In his spare time, Mike has taken courses in mathematics and education at Northwestern University and looks forward to be a volunteer tutor for high school or college students. He is also a reader of classic literature, mathematics, and philosophy.

His greatest pride are his two daughters; one a behavior analyst who works with young autistic children and the other a photo art conservator who currently works at MOMA.

Mikes believes efficiency and quality are directly proportional. In order to deliver quality construction documents, a firm must work efficiently. This must include good detailing. Good design and good detailing is smart for business.



Because your reputation is on the line every day.

We make DuPont™ Tyvek® CommercialWrap® for professionals who build quality into every job. After all, it's architects and contractors like you who have made us the industry leader for over 25 years. And you're why we continue to develop innovative products, systems and services for the commercial market, like the 10-Year Limited Warranty that gives added peace of mind with every job and the DuPont™ Tyvek® Specialist Network that supports you on and off the site. DuPont™ Tyvek® Weather Barrier Systems—they're all about building a better and even stronger reputation.

For more information contact:

Matthew Reed

Market Development Manager

Senior Certified DuPont Tyvek Commercial Specialist

(630) 788-0969



Tyvek.

DuPont™ Tyvek®: CommercialWrap® • Wrap Caps • Tape | DuPont™: FlexWrap™ • StraightFlash™ • StraightFlash™ VF • Fluid Applied WB

© 2016 DuPont. All rights reserved. The DuPont Oval logo, DuPont™, Tyvek®, Tyvek® CommercialWrap®, FlexWrap®, StraightFlash™ and StraightFlash™ VF are registered trademarks or trademarks of E.I. du Pont de Nemours and Company or its affiliates.

16-0130

Beyond the Chapter

CSI Chicago Members activities beyond Chicago Chapter

The following is a list of members of the Chicago Chapter of the Construction Specifications Institute that are volunteering for construction industry activities beyond the Chicago Chapter of CSI.

I hope to receive information regularly to expand this list and keep it current so that we can all be informed as to the breadth of member activities. Please send your construction industry volunteer activity information to me at: josephstypka@gmail.com or joseph.stypka@perkinswill.com.

Thank you,
Joe Stypka

Member Activities Beyond

Randy Chapple

Construction Specifications Institute Delegate to the Tile Council of North America (TCNA) Handbook Committee and to the ANSI A108 Accredited Standards Committee for Ceramic Tile
Member of the U.S. Technical Advisory Group to ISO Technical Committee 189 on Ceramic Tile
Committee member of ASTM E2751/E2751M "Design and Performance of Supported Laminated Glass Walkways"

Larry Church

American Concrete Institute: Committee member of: 365 – Service Life Prediction, 362 – Parking Structures, 364 – Rehabilitation, 130 – Sustainability, and 329 – Performance Design of Concrete.
National Parking Association / Parking Consultants Council: member of the PCC
Precast/Prestressed Concrete Institute: active member with the Parking Structure and Sustainability Committees

Scott Conwell

International Masonry Institute (IMI) Delegate to the Tile Council of North America (TCNA) Handbook Committee and to the ANSI A108 Accredited Standards Committee for Ceramic Tile
Member of the U.S. Technical Advisory Group to ISO Technical Committee 189 on Ceramic Tile

Jeff Diqui

Building Enclosure Council – Chicago chapter, Program Director
Air Barrier Association of America (ABAA) Terminations and Flashings Committee

Renee Doktorczyk

Member of CSI North Central Region, Institute Director Nominating Committee

Frank Heitzman

Construction Specifications Institute, UDS Program Task Team

Alan Itzkowitz

Construction Specifications Institute, Director from the North Central Region
Specifications Consultants in Independent Practice (SCIP), Vice President

Section continued on the next page...

Beyond the Chapter

Chicago CSI Members activities beyond Chicago Chapter (cont.)

Bill McHugh

ASTM E06.21-16 Task Group Chair – Firestop Inspection Standards ASTM E 2174 and ASTM E 2393
NFPA Fire Protection Features Committee Member
National Roofing Contractors Association Membership Steering Committee Member

Elias Saltz

Construction Specifications Institute, Practice Area Curriculum Committee
CSI North Central Region Electronic Communications Chair

Brad Schwab

CRCA (Chicago Roofing Contractors Association) Board, Associate Board Member

Joe Stypka

American Institute of Architecture (AIA), Vice-Chair MasterSpec Architectural Review Committee



We're more than just a paint company

- Extensive National Architectural Program
- Product and Environmental Certifications



Master
Painters
Institute

BEHR
behr.com/architect

Chapter News

Gettin' Social With It

(Continued from cover.)

By Brad Schwab

If you are following CSI Chicago on Social Media you have noticed an increased amount of posts and content within the last month. The Communication and Social Media Committees have worked together to increase our activity to keep members informed and to attract new members.

As we all know, the one thing that sets CSI Chicago apart from others is our members and our educational content and programming. In todays beyond busy world it is more important than ever to continue to market and inform members and prospective members about CSI Chicago. Social Media is perfect for CSI Chicago because it essentially relies on three things - a great network of people, great content and consistency. We were just missing the consistency.



The Communication and Social Media Committees have worked together to develop a process that will allow us to consistently post the great content and events that our membership works so hard to create. We now need our members help. If you are on Social Media please consider the following to help our chapter continue to grow.

Follow Us - If you are on Facebook, Twitter or LinkedIn please follow/like us by searching for CSI Chicago in one of the above social media platforms or clicking on the images on the right.



Like and/or Share Our Posts – The more likes and shares a post has, the more likely it is to show up in people's News Feeds. So the more likes and shares will help us stay top of mind in members News Feeds plus it will help grow awareness among prospective members in your social network.

Please Join Us to Honor CSI Chicago Members Scott Conwell and Kurt Moehlmann

CSI Chicago will be hosting a reception on October 23 at 4:00pm, prior to our October Chapter Meeting, at the East Bank Club in Chicago. Scott Conwell (right) will be elevated to Fellow and Kurt Moehlmann (far right) will receive the Andrew J. Drozda Mentorship Award at the CSI 2018 honors and awards recipients at CONSTRUCT.

If you are able to join us for the celebration please indicate your attendance when you [register](#) for the October 23 Chapter Meeting.

If you will attend the reception but are not able to stay for the Chapter Meeting immediately following, please RSVP to Beth Winkler at administration@csichicago.org.



Section continued on the next page...

Chapter News

Communicating with CSI Chicago Just Got Easier

Update your records - we have upgraded our website URL and email addresses. Be sure to add these e-mail address to your address book to stay connect with us.

- www.csichicago.org - it's easy to remember our new URL which will take you to CSI Chicago's website - <http://www.csiresources.org/chicagochapter>
- **Beth Winkler** administration@csichicago.org - Executive Director Beth Winkler is an email away. Update your Beth Winkler email address today and note when you receive emails from this address, Beth needs your assistance.
- **Membership Team** membership@csichicago.org - All general chapter membership inquiries are under one branded email. If you have any questions or thoughts about membership please direct them to this new branded email address which goes directly to the membership committee.
- **Certification Team** certification@csichicago.org - All general chapter certification inquiries are under one branded email. If you have any questions or thoughts about certification please direct them to this new branded email address that goes directly to our certification committee.
- **News and General Inquires** info@csichicago.org - All general CSI Chicago inquiries and general communications will utilize this new branded email address.

CAC Building Envelope Foundation Scholarship Award

CAC Building Envelope Foundation is proud to announce 2018 fall semester Scholarship recipients, who are all seniors at the Illinois Institute of Technology (IIT), and are majoring in either Architectural Engineering or Civil Engineering:

Xavier John • Esther Nazziwa •
Khadijah Nesbitt • Joshua Wolf

[Learn more.](#)



BLUE LINE BUILDING ★ PRODUCTS

Independent Manufacturers Rep

"The Right Product for the Right Application"

Morin®

A Kingspan Group Company

FUNDERMAX®

for people
who create



www.Bluelinebp.com

Matt Martino

773.251.0066

mmartino@bluelinebp.com

Chapter News

Event Recap

Member Reception and Trivia Night: Tuesday, September 18, 2018

How many Attendees and Trivia Teams does it take to make a New Member Reception/Trivia Night successful? The trivia answer is 65 attendees and 11 teams.

Thank you to our trivia master Jeremy Olsen and our event sponsors ([Aristech Surfaces](#), [Blue Line Building Products](#), [General Shale Arriscraft](#), [Hilti](#) and [MAPEI](#)) for a great social event to kick off our 2018/2019 CSI Programming Season.

We welcomed 13 new members at Ballast Point Brewpub on Green St. in Chicago. The casual yet lively space was exactly what the event called for and the over 40+ beers on tap along with the taco bar gave the trivia teams the fuel then needed for success. Team Bubblegum Pop took home the championship gift cards while team Awesome Tacos took home the consolation gift card for the lowest points. A good time was had by all and if you didn't make it this year keep a look out for it next year.

Thank You Member Reception/Trivia Night Sponsors



Chapter News

Event Recap

Chapter Meeting: Tuesday, September 25, 2018 Buildings as Product: Exploring the Benefits of Factory-Manufactured Buildings for the 21st Century

Skender graciously hosted 105 attendees to kick off CSI Chicago's fall chapter meetings with a riveting presentation from Skender's Chief Design Officer, Tim Swanson, on "Buildings as Products."



Over the course of an hour, Tim walked us through the precision assembly processes of automobile and other manufacturing sectors that could potentially translate into the construction industry. Below are the key takeaways that Patrick Reicher of Raths, Raths, and Johnson took from the presentation:

- Construction technology and processes have been stagnant for the past 25 years. During that time, automated assembly processes have permeated the manufacturing sector and offer endless possibilities to improve construction methodologies.
- There is great potential for significant productivity improvement in construction. While construction-related spending accounts for 13 percent of the world's gross domestic product (GDP), the sector's annual productivity growth hovers around 1 percent per year.
- While understanding that construction sites have extraordinarily complex coordination and scheduling challenges, many site-related issues may be overcome by constructing significant portions of buildings faster and better in a controlled factory environment.
- There have been documented issues with modular manufacturing and construction technologies in the past. However, as design methodologies and understanding of assembly tolerances continue to improve, interest in the use of modular construction continues to grow.

This program was featured as part of CSI Chicago's annual Contractor Engagement Month. Thanks to the outreach efforts of the Contractor Engagement Committee, we were thrilled to welcome the 20 contractors registered to take part in our program.

Special thanks to Tim Swanson for taking the time to share with our group, and to Skender for hosting us in your exceptional presentation space. We also thank our tabletop presenters for sharing with us that evening: Aristech Surfaces, ASSA ABLOY, Hager, Intus Windows, and MAPEI.



Hot Tip of the Month

Provided by Shaun Faulkner

Maps Tell a Story. Check Out What You're Missing

This month's Hot Tip of the Month comes from member Shaun Faulkner of PPG Paints. As an Architectural Specification + Design Representative he uses BatchGeo maps to map his customer accounts which allows him to be more efficient with his time.

Any business can benefit from BatchGeo's location data visualization. Maps can be used to explore sales leads, for example. Or add retailers to a map and quickly add a store locator to your website. Store any business data with geographic information securely in BatchGeo and explore it visually for insights you might not find any other way.



For more information or to try their free tool visit batchgeo.com.

PRODUCTS FOR
CONCRETE
RESTORATION

WALL PROTECTIVE AND
DECORATIVE COATINGS

AD MIXTURES
FOR CONCRETE

PRODUCTS FOR
STRUCTURAL
STRENGTHENING

PRODUCTS FOR
LARGE PROJECTS,
DAMS, CANALS
AND VIADUCTS

PRODUCTS FOR
TILE AND STONE

PRODUCTS FOR
ROAD
MAINTENANCE

PRODUCTS FOR
SPORTS
FACILITIES

PRODUCTS FOR
CEMENTITIOUS
AND RESIN
FLOORING

PRODUCTS
FOR UNDERGROUND
CONSTRUCTION

ELASTIC SEALANTS
AND ADHESIVES

PRODUCTS FOR
SYNTHETIC TURF

PRODUCTS FOR
RESILIENT AND
CARPET FLOORING

PRODUCTS FOR
ACOUSTIC
INSULATION

PRODUCTS FOR
BELOW-GRADE
WATERPROOFING

PRODUCTS FOR
WOOD FLOORING

THE WORLD OF MAPEI

TOTAL ARCHITECTURAL SOLUTIONS

As the leading global manufacturer of mortars, grouts and adhesives, MAPEI also offers the full spectrum of chemical products for construction projects – everything from dams, bridges and tunnels to malls, hospitals and condominium towers. We partner with the architectural community by providing a single source for system specifications, technical expertise/consultation and practical online architectural tools.

www.mapei.us/architects
Illustrations by Carlo Stanga

MAPEI
ADHESIVES - SEALANTS - CHEMICAL PRODUCTS FOR BUILDING

Sponsorship and Marketing

We have many sponsorship and marketing opportunities throughout the year. These opportunities are a great way to increase your company's presence in the Chicago market while showing your support in the Chicago chapter.

Upcoming Sponsorship Opportunities

Chapter Meeting Tabletop | Tuesday, November 26, 2018, 5:00pm | East Bank Club, Chicago

- \$200 members, \$300 non-members (Non-members also must also pay event registration fee).
- Members can book tabletops 60 day prior to event, non-members can book 30 days prior.
- Tabletop during networking time, opportunity to introduce yourself to the program attendees, sponsorship of a raffle prize (prize included in fee), recognition in following month's newsletter.
- Limit 2 tabletops per programming year (September 2018 - May 2019).

Holiday Party Event Sponsor | Thursday, December 13, 2018, 5:30pm | Eric Cafe, Chicago

- \$200 members and non-members
- Includes 1 event ticket.
- Recognition at event, in chapter newsletter and on social media.
- Proceeds of the raffle benefit CSI Chicago's Rebuilding Together 2019 Home Adoption.

Holiday Party Raffle Sponsor | Thursday, December 13, 2018, 5:30pm | Eric Cafe, Chicago

- Donate a raffle prize, gift card, or money to purchase a prize for our fundraising raffle.
- Recognition in chapter newsletter and donor name on prize.
- Proceeds of the raffle benefit CSI Chicago's Rebuilding Together 2019 Home Adoption.

Give Back with CSI Chicago

- **Home Adoption and Rehab:** Donate money or a Home Depot gift card of any amount for CSI Chicago's Rebuilding Together 2019 Home Adoption. Home selection happens in December 2018. Home will be rehabbed through volunteer labor on April 29, 2019. [Take a look at our rehab from 2018.](#)
- **Student Scholarship:** Donate money to our Student Scholarship Fund and support local IIT Architect Students
- **Future Cities Competition:** Help the chapter sponsor an award for the 2019 Chicago Regional Competition held in January. Contribute some or all of the \$300 sponsorship cost.

For more information on all our marketing and sponsorship opportunities, [visit us online](#). To book your sponsorship, please contact us at administration@csichicago.org

Thank you to our Chapter Partners

Thank you to our partners who continue their support for another year with partnership this month.

Platinum Partner



Platinum Partner



Gold Partner



Chapter Partners support CSI Chicago chapter and continue the high level of programming and education throughout the year. [Connect with our partners>>>](#)

Institute and Regional News

CONSTRUCT 2018:

Register to attend and participate in the exceptional accredited education program. With 6 tracks to select from,

there are sessions for every discipline in the commercial AEC industry. Earn up to 17.25 hours of continuing education credits, including AIA LUs/HSW, BOMI, GBCI, ICC, NARI, and RCI.

Learn more at Constructshow.com



EDUCATION: October 3-5, 2018
EXHIBITS: October 4 & 5, 2018
Long Beach, CA

Customize Your Volunteer Experience with CSI's Volunteer Portal

Sign up for opportunities at CSI's NEW Volunteer Portal:

- See all volunteer opportunities in one location

- Easily apply for options that interest you and work with your schedule

- Opt into the volunteering pool, sit back and have volunteering invitations come directly to you

Join your fellow members... Jump into the [volunteer pool](#) and make a difference!

See how you can volunteer today on the [Volunteer Portal](#). If you have any questions about volunteering, please email volunteer@csinet.org.

The Construction Specifier is the official magazine of CSI. [Click here](#) to view the latest issue.

Stay connected with the NCR at www.csinc.org and the Institute at www.csiresources.org.

TECHNICAL
CAPABILITIES.

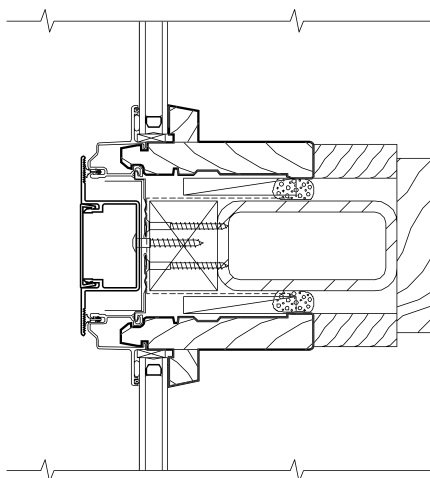

ENVIRONMENTAL NATURE CENTER
NEWPORT BEACH, CA
ARCHITECT: LPA, INC.

CREATIVE
POSSIBILITIES.

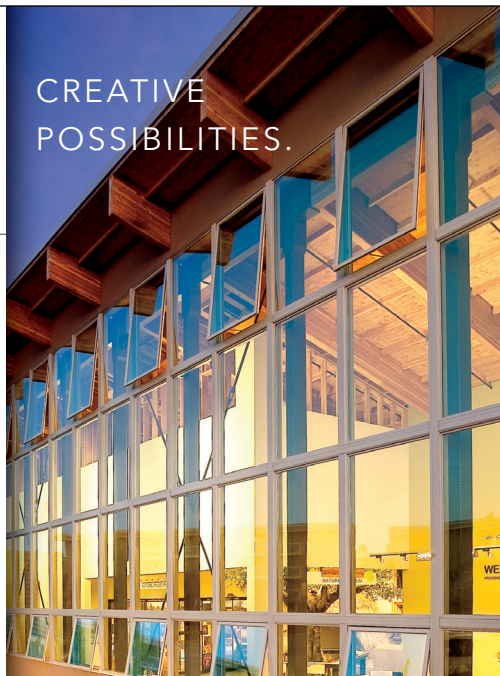

Pella Windows & Doors

Chris Carpenter, CSI, CCPR
Architectural Representative

630.675.4750
ccarpenter@pella.com

pellacommercial.com

See both sides of this story at pellacommercial.com/enc.



COMMERCIAL

© 2012 Pella Corporation
Photo © Costea Photography, Inc.

Industry Events

2-Day Air Barrier Educational Symposium & Installation Rodeo

Join us for two unique days of air barrier education! Wed. Oct. 17 & Thurs. Oct. 18

Day 1 Educational Programs, 8am - 4:15pm, 5.75 CEU

Bank of America Building, 135 South LaSalle, 43rd Floor, Chicago, IL 60603

Day 2 Hands-On Mockup Installation Sessions, 8am - 3:00pm, 5.5 CEU

International Masonry Institute, 2140 W. Corporate Dr., Addison, IL 60101

REGISTRATION (mandatory) AND DETAILED AGENDA: <https://goo.gl/9C4HTs>



Windy City Symposium on Building Science & Advanced Roofing Technology

October 23, 2018, 8:00am - 12:30pm

You're invited to join your fellow design professionals and building owners for a morning of presentations on advanced roofing and waterproofing technology, and the role of roofing and waterproofing in the building envelope.

The Great Building Transition: Roofs & Walls

Featured Speaker: Dr. Joe Lstiburek, Ph.D., P. Eng., ASHRAE Fellow, Building Science Corporation

The Real World is a Roof's Enemy. How Science Should Drive the Choice.

Kirk Goodrum, Siplast Research & Technical Development Manager

Non-traditional Roof Insulation Solving Common, Non-Traditional Problems

John Rose, Manager, Siplast Lightweight Insulating Concrete

Liquids: a 21st Century Solution for Urban Buildings

John Thomas, Manager, Siplast Liquid-Applied Roofing & Waterproofing

Solving a Real World Problem with Green Roofing to Protect National Treasures

Corey O'Connor, Principal, General Material Associates

The registration fee is \$40, which includes breakfast, lunch, symposium materials, and self-parking. Proceeds from the Symposium will be donated to RCI and CSI Chicago Chapter Charities.



Limited Seating! [Learn more and register now online](#)
or call 1.800.922.8800

Section continued on the next page...



Roofing and Waterproofing Systems

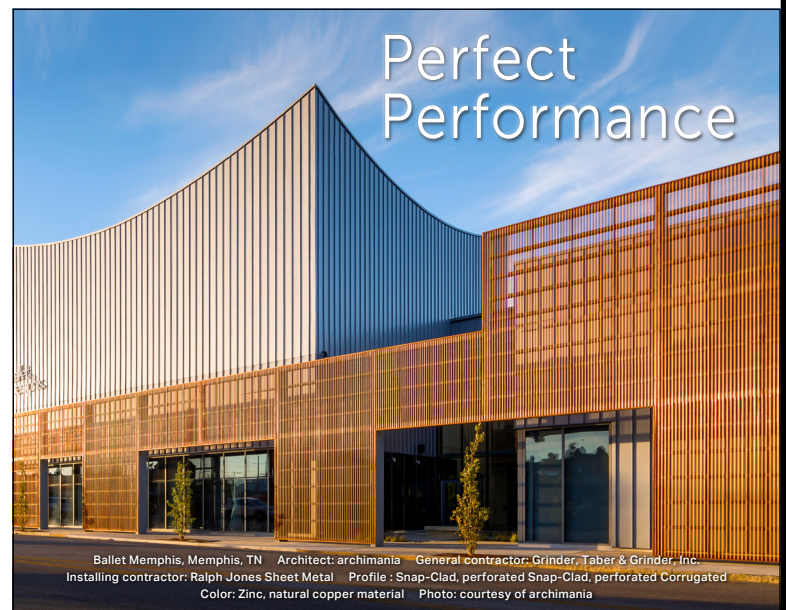

Ballet Memphis, Memphis, TN Architect: archimania General contractor: Grinder, Taber & Grinder, Inc.
Installing contractor: Ralph Jones Sheet Metal Profile: Snap-Clad, perforated Snap-Clad, perforated Corrugated
Color: Zinc, natural copper material Photo: courtesy of archimania

"We wanted to make the project dynamic and energized. The copper screen looks more solid during the day and perforated at night when lights are on behind it—enhancing the urban experience within the entertainment district."

-Todd Walker, FAIA, Principal, archimania

Case study at PAC-CLAD.COM/BALLETMEMPHIS

PAC-CLAD.COM | INFO@PAC-CLAD.COM

IL: 800 PAC CLAD
AZ: 833 750 1935
GA: 800 272 4482

MD: 800 344 1400
MN: 877 571 2025
TX: 800 441 8661



Industry Events

DELTA® Academy Advanced Building Performance Program presents

The Perfect Wall: Building Better Enclosures

Presented by Dr. John Straube

Tuesday, October 30, 2018, 8:00 am-6:00 pm CDT

Location: Marshall's Landing Chicago at the MART,
222 Merchandise Mart Plaza, Suite #225, Chicago

Credit: 5 AIA LU/HSW hours.

Cost: \$50 (USD)



Join John Straube Ph.D., P.Eng., a Principal at RDH Building Science and expert in building enclosure performance, as he covers the key principles of building enclosure design. Learn how the right materials in the right order can improve durability, comfort, and thermal performance!

This seminar will cover key principles of building enclosure design, including a discussion of the “perfect wall” concept—and beyond. Through industry research and field experience, you'll learn about rain control, as well as the connections between airtightness, vapor permeability, durability, and energy efficiency.

[To see the full course description, agenda, and more about our speaker, Dr. John Straube and to register click here.](#)

For questions, contact your local representative: Doug Holmes, CSI at 312-438-0721 or dholmes@dorken.com.

Registration available for the largest conference and expo dedicated to Green Building

Greenbuild International Conference and Expo is the in-person experience for sustainability in the built environment.

The event is from November 14-16 at McCormick Place.

[Learn More.](#)



CSI Chicago Members know as well as anyone - green building isn't a temporary fad, and it's more than a movement; it's a responsibility. We all have a hand in it. Let's commit to a brighter future - one where sustainable buildings and environments are accessible to everyone. Register for three days of education. Or, explore the floor, courtesy of CSI Chicago. (Use code **4DINCOMPE7** to claim your free expo pass.)

[Register Now.](#)

Jeff M. Diqui
*Director, Industry Development
and Technical Services*

Office: 630-396-7141

Cell: 630-606-8220

jdiqui@imiweb.org

2140 W. Corporate Drive
Addison, IL 60101



Leadership Directory

Officers and Directors July 2017 - June 2018



President
[Peter Grotenhuis](#)
CSI, CDT



President-elect
[Andrea Baird](#)
CSI, CCCA, AIA, P.E., LEED AP



Vice President 2019
[Heather Rice](#)
CSI, CDT



Vice President 2020
[Jennifer Friedland](#)
CSI, CDT, LEED GA



Secretary 2019
[Chris Carpenter](#)
CSI, CCPR



Treasurer 2019
[Elias Saltz](#)
CSI, CCS, LEED AP



Membership Officer 2019
[Robert Moretti](#)
MBA, CSI, CDT



Director 2019
[Scott Conwell](#)
CSI, CDT, FAIA, LEED AP



Director 2019
[Renee Doktorczyk](#)
FAIA, CSI, CCS, SCIP



Director 2019
[Chris Walsh](#)
CSI, CDT, LEED GA



Director 2020
[Guadalupe Casimiro](#)
CSI



Director 2020
[Randall Chapple](#)
CSI, CCS, AIA, SE



Director 2020
[Brad Schwab](#)
CSI, CDT



Past President
[Melissa Gibson](#)
NCARB, CSI, CCS, CCCA, LEED AP BD+C



N. Central Region Director
[Drew Clausen](#)
CSI



Executive Director
[Beth Winkler](#)

Board meetings are typically held 1 hour prior to chapter meetings and open to all members to attend. If you would like to attend, send RSVP to administration@csichicago.org.

Leadership Directory

Committee Members and Coordinators

Operations Committees

Nominating	Chair	Melissa Gibson, NCARB, CSI, CCS, CCCA, LEED AP BD+C	mgibson@epsteinglobal.com
Nominating	Committee	Peter Grotenhuis, CSI, CDT	peter.g@greengirt.com
Nominating	Committee	Andrea Baird, CSI, CCCA, AIA, P.E., LEED AP	albaird@rrj.com
Finance	Chair	Elias Saltz, CSI, CCS, LEED AP	esaltz@gmail.com
Finance	Committee	Peter Grotenhuis, CSI, CDT	peter.g@greengirt.com
Finance	Committee	Melissa Gibson, NCARB, CSI, CCS, CCCA, LEED AP BD+C	mgibson@epsteinglobal.com
Finance	Committee	Andrea Baird, CSI, CCCA, AIA, P.E., LEED AP	albaird@rrj.com
Awards - Chapter	Chair	Peter Grotenhuis, CSI, CDT	peter.g@greengirt.com
Awards - Institute	Chair	Melissa Gibson, NCARB, CSI, CCS, CCCA, LEED AP BD+C	mgibson@epsteinglobal.com
Awards - Regional	Chair	Andrea Baird, CSI, CCCA, AIA, P.E., LEED AP	albaird@rrj.com
By-Laws	Chair	Randall A. Chapple, CSI, CCS, AIA, SE	rchapple@gpchicago.com
Historian	Chair	Joseph A. Stypka, FCSI, CCS, FAIA	Joseph.Stypka@perkinswill.com
Historian	Committee	Elias Saltz, CSI, CCS, LEED AP	esaltz@gmail.com
Continuing Education	Coordinator	Joseph A. Stypka, FCSI, CCS, FAIA	Joseph.Stypka@perkinswill.com
Continuing Education	Committee	Scott Conwell, CSI, CDT, FAIA, LEED AP	sconwell@imiweb.org
Partners & Sponsorship	Chair	Drew Clausen, CSI	drew.clausen@owenscorning.com
Partners & Sponsorship	Committee	Scott Conwell, CSI, CDT, FAIA, LEED AP	sconwell@imiweb.org
Partners & Sponsorship	Committee	Peter Grotenhuis, CSI, CDT	peter.g@greengirt.com

Communication Committees

Communications	Chair	Brad Schwab, CSI, CDT	bschwab@schwabgroup.net
Communications	Committee	Peter Grotenhuis, CSI, CDT	peter.g@greengirt.com
Communications	Committee	Rachel Nava, CSI, CDT	rachelnava@yahoo.com
Social Media	Chair	Holly Hirsch, CSI	Holly.Hirsch@boral.com
Social Media	Committee	Thad Goodman, FCSI, CCPR	thadg@nationalgypsum.com
Social Media	Committee	Kira Rogatnik, CSI, CDT	krogatnik@metlspan.com
Social Media	Committee	Heidi Cervantes, CSI	hcervantes@fitzgeraldassociates.net

Membership and Outreach Committees

Membership	Chair	Robert Moretti, MBA, CSI, CDT	rmoretti@tremcoinc.com
Membership	Committee	Chris Walsh, CSI, CDT, LEED GA	cwalsh@inprocorp.com
Membership	Committee	Randall A. Chapple, CSI, CCS, AIA, SE	rchapple@gpchicago.com
Membership	Committee	Jeremy T. Olsen, CSI, CCS, CCCA, AIA, LEED AP	Jeremy@daylightstudioarch.com
Membership	Committee	Renee Doktorczyk FAIA, CSI, CCS, SCIP	renee@architechspec.com
Membership	Committee	Jessica Newell, CSI	Jessica.Newell@sherwin.com
Student/Academic Affairs	Chair	Valarie Vlahos Maes, CSI	vmaes@flexcofloors.com
Student/Academic Affairs	Committee	Peter Grotenhuis, CSI, CDT	peter.g@greengirt.com
Student/Academic Affairs	Committee	Thad Goodman, FCSI, CCPR	thadg@nationalgypsum.com
Contractor Engagement	Chair	Jennifer R Friedland CSI, CDT, LEED GA	Jennifer.R.Friedland@saint-gobain.com
Contractor Engagement	Committee	Heather Rice CSI, CDT, ICRI Certified	heather@smartconcretetech.com
Contractor Engagement	Committee	Patrick J. Duffy, Jr., CSI, CCPR	pduffy@abuildingproducts.com
Contractor Engagement	Committee	Scott Conwell, CSI, CDT, FAIA, LEED AP	sconwell@imiweb.org
Contractor Engagement	Committee	Jeremy T. Olsen, CSI, CCS, CCCA, AIA, LEED AP	Jeremy@daylightstudioarch.com
Contractor Engagement	Committee	Kathy St. Joseph, CSI	k.stjoseph@lottechem.com
Contractor Engagement	Committee	Garest Hovest, CSI	garrett.hovest@basf.com
Contractor Engagement	Committee	Kathleen McGinley, CSI	KMcGinley@mapei.com
Emerging Professionals	Chair	Valarie Vlahos Maes, CSI	vmaes@flexcofloors.com
Emerging Professionals	Committee	Ilyssa Kaserman, CSI-EP, CDT, LEED AP	kaserman.ilyssa@gmail.com
Emerging Professionals	Committee	Rachel Nava, CSI, CDT	rachelnava@yahoo.com

Section continued on the next page...

Leadership Directory

Committee Members and Coordinators (cont.)

Education Committees

Technical	Chair	Randall A. Chapple, CSI, CCS, AIA, SE	rchapple@gpchicago.com
CDT Exam Study Class	Co-Chair	Larry Nordin, CSI, CCS, AIA	larry.nordin@scb.com
CDT Exam Study Class	Co-Chair	Nolan Day, CSI, CDT	twoday@sbcglobal.net
CDT Exam Study Class	Co-Chair	Paul Fogarty, CSI, CDT	paul@sjmallein.com
CSi2eye	Chair	Drew Clausen, CSI	drew.clausen@owenscorning.com
CSi2eye	Committee	Kurt Moehlmann, CSI, CDT	rpikurt@aol.com
CSi2eye	Committee	Kira Rogatnik, CSI, CDT	krogatnik@metlspan.com
CSi2eye	Committee	Alan Itzkowitz, AIA, FCSI, CCS, CCCA, NCARB, LEED AP	alan.itzkowitz@gmail.com
Programs	Chair	Andrea Baird, CSI, CCCA, AIA, P.E., LEED AP	albaird@rrj.com
Programs	Committee	Kimberly Lis, CSI	klis@wje.com
Programs	Committee	Jennifer R Friedland CSI, CDT, LEED GA	Jennifer.R.Friedland@saint-gobain.com
Programs	Committee	Timothy Blatner, CSI, CDT, LEED AP	tblatner@fitzgeraldassociates.net
Programs	Committee	Melissa Gibson, NCARB, CSI, CCS, CCCA, LEED AP BD+C	mgibson@epsteinglobal.com
Programs	Committee	Jeremy T. Olsen, CSI, CCS, CCCA, AIA, LEED AP	Jeremy@daylightstudioarch.com
Programs	Committee	Matt Reed, CSI, CDT	mreed@parksite.com
Programs	Committee	Randall A. Chapple, CSI, CCS, AIA, SE	rchapple@gpchicago.com
Roundtable - Industry	Chair	Scott Conwell, CSI, CDT, FAIA, LEED AP	sconwell@imiweb.org
Roundtable - Industry	Committee	Robert Moretti, MBA, CSI, CDT	rmoretti@tremcoinc.com
Roundtable - Industry	Committee	Chris Carpenter, CSI, CCPR	ccarpenter@pella.com
Roundtable - Meet the Rep	Chair	Pat Ruban, CSI	patruban10@yahoo.com
Roundtable - Meet the Rep	Committee	Shana Kim, CSI, CDT	skim@antunovich.com
Roundtable - Meet the Rep	Committee	Kurt Moehlmann, CSI, CDT	rpikurt@aol.com
Roundtable - Meet the Rep	Committee	Melissa Gibson, NCARB, CSI, CCS, CCCA, LEED AP BD+C	mgibson@epsteinglobal.com
Roundtable - Specifier	Chair	Melissa Gibson, NCARB, CSI, CCS, CCCA, LEED AP BD+C	mgibson@epsteinglobal.com
Roundtable - Specifier	Committee	James Cross, CSI, CCS, AIA	j.cross@studiogc.com
Roundtable - Specifier	Committee	Randall A. Chapple, CSI, CCS, AIA, SE	rchapple@gpchicago.com
Roundtable - Specifier	Committee	Larry Nordin, CSI, CCS, AIA	larry.nordin@scb.com
Roundtable - Summer	Chair	Jeremy T. Olsen, CSI, CCS, CCCA, AIA, LEED AP	Jeremy@daylightstudioarch.com
Roundtable - Technical	Chair	Timothy Blatner, CSI, CDT, LEED AP	tblatner@fitzgeraldassociates.net
Roundtable - Technical	Committee	Jeremy T. Olsen, CSI, CCS, CCCA, AIA, LEED AP	Jeremy@daylightstudioarch.com
Roundtable - Technical	Committee	Jeff Diqui, CSI	jdiqui@imiweb.org

Social Committees

Rebuilding Together	Chair	Guadalupe Casimiro, CSI	gcasimiro@jandhltd.com
Rebuilding Together	Committee	Francisco Rosas, CSI	frosas@jandhltd.com
Rebuilding Together	Committee	Kathy St. Joseph, CSI	k.stjoseph@lottechem.com
Rebuilding Together	Committee	Paul Larson, CSI	paul@comstructsales.com
Rebuilding Together	Committee	Heather Salisbury, CSI	hsalisbury@buildordie.com
Social	Chair	Kristin Henriksen, CSI, CDT	k_henriksen14@yahoo.com
Social	Committee	Kira Rogatnik, CSI, CDT	krogatnik@metlspan.com
Social	Committee	Karen Swank, CSI	swankks@pella.com
Golf Outing	Chair	Nolan Day, CSI, CDT	twoday@sbcglobal.net
Golf Outing	Committee	Kurt Moehlmann, CSI, CDT	rpikurt@aol.com
Golf Outing	Committee	Chris Walsh, CSI, CDT, LEED GA	cwalsh@inprocop.com

If you are interested in joining a committee or have questions about a committee, please contact the chapter president, executive director, or committee chair.

Looking Ahead to the 2018 Illinois Energy Conservation Code

By: Christopher E. Chwedyk, CSI, AIA

Illinois is in the process adopting the 2018 Illinois Energy Conservation Code (Illinois Energy Code). As required by state law, Illinois must adopt amendments to the Illinois Energy Code based on the latest version of the International Energy Conservation Code (IECC), a model code that is updated on a three-year cycle. The new version of the Illinois Energy Code will be based on the 2018 IECC. Over three posts, we will preview some of the changes we are likely to see in the 2018 Illinois Energy Code.

The state has made considerable progress in mandating buildings' energy efficiency over the last 15 years. In 2002, only 25 percent of local Illinois jurisdictions had some building energy code provisions. Chicago took the lead by adding a whole new chapter (18-13) to their building code in 2003, a modified version of the 2000 IECC, then in its second edition. However, the only means of enforcement was to require certification by Registered Energy Professionals (REP), licensed engineers or architects who attended special training classes. That same year, Illinois adopted the latest ASHRAE 90.1 standard as part of the Illinois Capital Development Board (CDB) Act (20 ILCS 3105), that was only applicable to state-funded construction. [Read full post on *The Final Review*.](#)



Photo by Andrew Seaman.



—
YOUR REPUTATION STANDS ON A NAME

So Does Ours

—

Generation after generation, Marvin Windows and Doors has built our reputation through dedication – the same dedication you build into every home. Together, we share a commitment to design, personal attention and the unparalleled ability to customize. As partners, we both draw from these strengths to build a reputation that can be shared.

**CONTACT YOUR LOCAL, INDEPENDENT DEALER
TO DISCOVER THE MARVIN DIFFERENCE TODAY.**

MARVIN 
Windows and Doors

Built around you.®

© 2016 Marvin® Windows and Doors. All rights reserved. ® Registered trademark of Marvin Windows and Doors.
Builder: Seven Custom Homes, Austin, TX

The Closeout 8 East Huron

Contributed by: Valerio Dewalt Train Associates, Inc.



In 2012, CA Ventures began to develop a luxury residential project on the edge of the River North neighborhood of Chicago. The clients envisioned a sleek glass building with boutique units and amenities worthy of the modern idea of luxury. During the early stages of design, other architects had struggled to fit the intended program on such a small footprint. Valerio Dewalt Train was consequently brought on to solve the complexities of the site and to achieve the client's goals within the existing parameters.

As seen from the street, the completed 26-story residential tower is wrapped in glazing with accents of white Ceramitex sintered paneling. Protruding rows of balconies are semi-enclosed by the window wall, which continues above the roofline and is architecturally expressed on the amenity level. To achieve its sleek aesthetic, the concrete structure is tucked behind the glass, and all lateral members are placed in a hidden level below the pool among the building's mechanical systems.

At ground level, the building has two commercial spaces that face State St and Huron St. Through the lobby entrance on Huron, residents are greeted by concierge that sit among polished Calacatta marble and custom millwork. The 101 rentable units in the

building consist of studios, as well as 1, 2 & 3 bedroom units designed with high end finishes and floor to ceiling windows that provide breathtaking views of the city. Equipped with an outdoor swimming pool, demonstration kitchen, tv room and gym on the top floor, this development provides vibrant and exciting residences in the River North neighborhood.

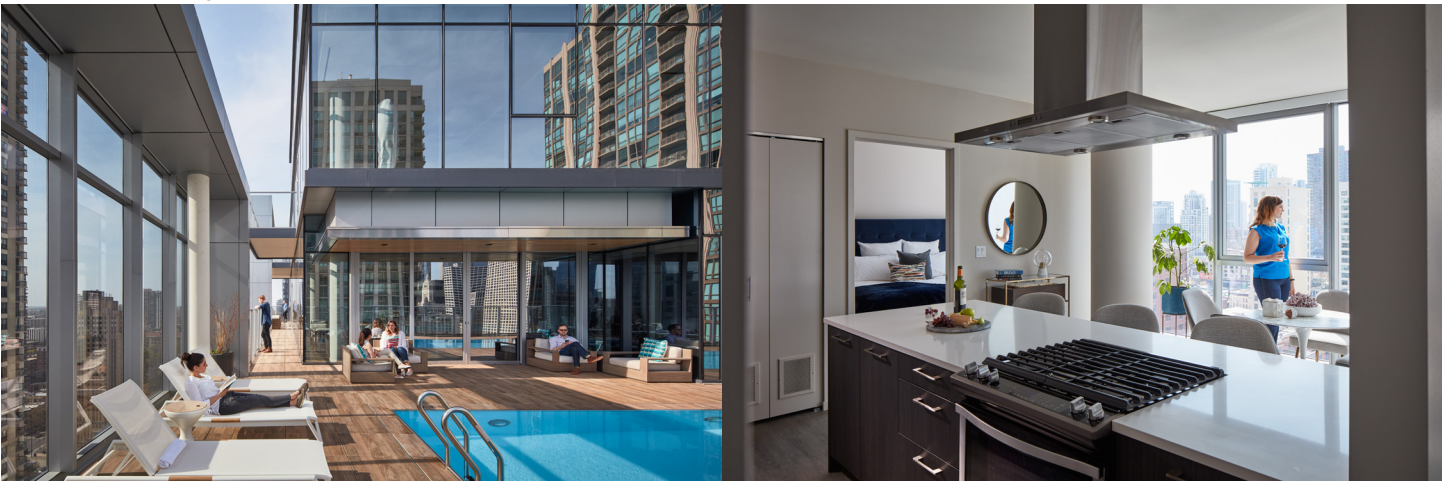

Photo Credit: Tom Harris

If you are interested in contributing a project closeout or other article for the newsletter, [click here to learn more.](#)